

Studs

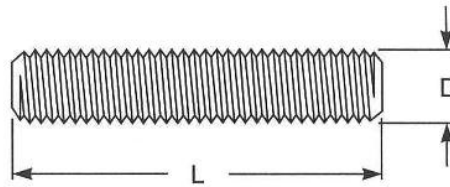

Three Foot Rod

Low Carbon Steel Plain- S020-----
 18-8 Stainless Plain- S188-----
 316 Stainless Plain- S316-----
 A193 - B7 Plain- SB70-----
 A193 - B8 Plain- SB80-----
 A193 - B8M Plain- SB8M-----
 Aluminum Plain- SALM-----
 Nylon Plain- SNYL-----

Twelve Foot Rod

Low Carbon Steel Plain- S020-----
 18-8 Stainless Plain- S188-----
 316 Stainless Plain- S316-----
 A193 - B7 Plain- SB70-----
 A193 - B8 Plain- SB80-----
 A193 - B8M Plain- SB8M-----
 Aluminum Plain- SALM-----
 Nylon Plain- SNYL-----

Nominal Size	Weight	
	Per Inch	2 Heavy Hex Nuts
#4-40	.000167	
#5-40	.002583	
#6-32	.003	
#8-32	.0045	
#10-24	.00575	
¼-20	.010167	.0232
5/16-18	.016583	.0344
3/8-16	.024417	.0640
7/16-14	.0335	.0832
½-13	.044417	.1308
9/16-12	.0565	.1630
5/8-11	.07025	.2380
¾-10	.102917	.3860
7/8-9	.142083	.5940
1-8	.185917	.8500
1-1/8-8	.23425	1.184
1-1/4-8	.3015	1.572
1-3/8-8	.368583	2.040
1-1/2-8	.444833	2.620
1-5/8-8	.526333	
1-3/4-8	.615333	4.080
1 7/8-8	.711333	

Nominal Size	Weight	
	Per Inch	2 Heavy Hex Nuts
2-8	.81	5.98
2 ¼-8	1.04	8.38
2 ½-8	1.29	11.28
2 ¾-8	1.57	14.76
3-8	1.88	19.00
3 ¼-8	2.23	
3 ½-8	2.59	30.52
3 ¾-8	2.99	
4-8	3.41	

Acme Rod	
Low Carbon Steel	S020---3---
Common Thread Pitches	
¼-16	1 1/8-5
3/8-12	1 ¼-5
1-2-10	1 ½-4
5/8-8	1 ¾-4
¾-6	2-4
7/8-6	
1-5	